

FORM NO. 1.

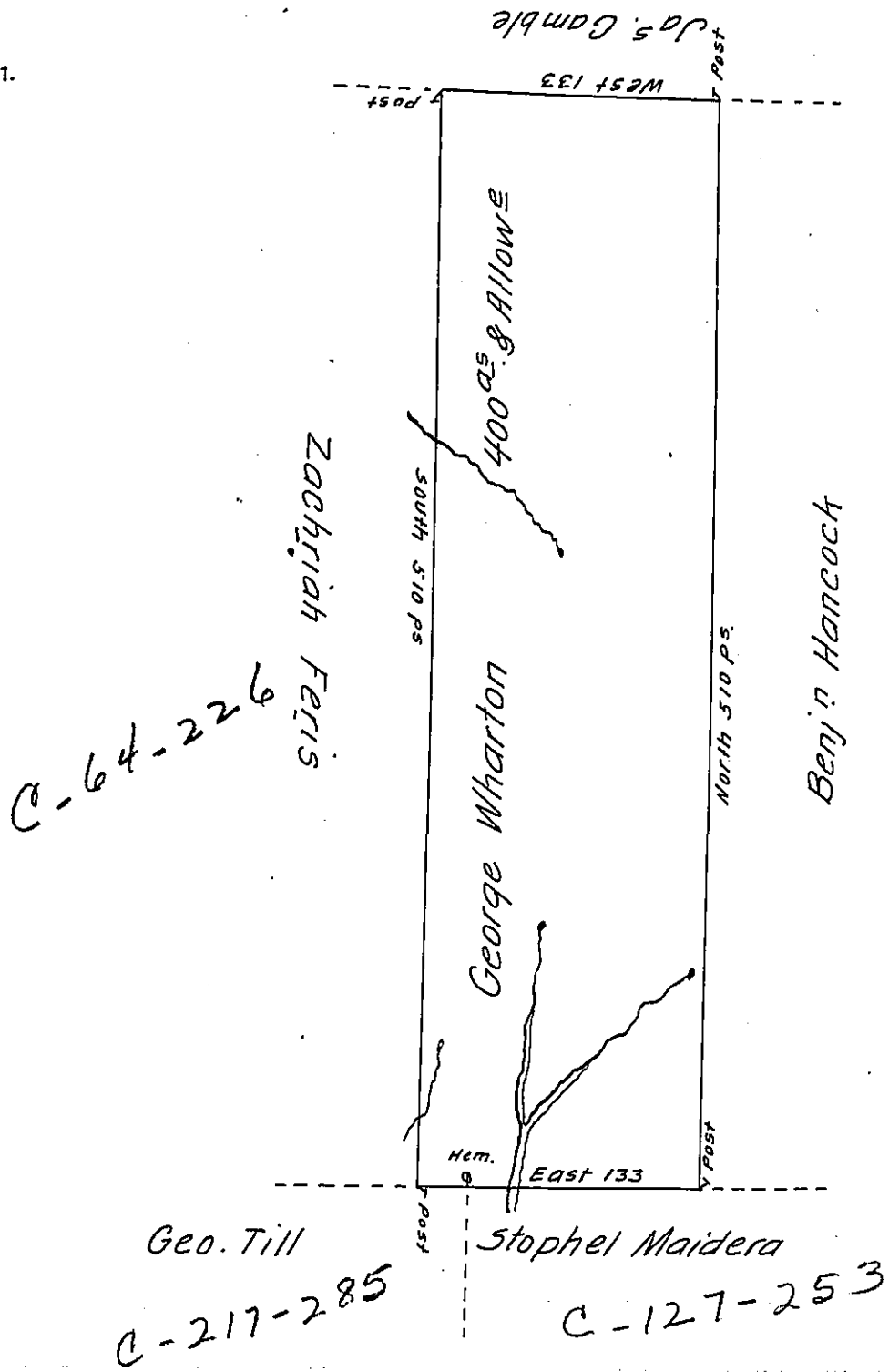

A Draft of a tract of land called ——— Situate on the waters of Wyolusing ^{and Wapasing} Creeks
 Joining land Surveyed for Benjⁿ Hancock & others in Northum^d County
 containing four hundred acres & Allowance of Six ⁸ Cent for Roads &c.
 Surveyed for Geo. Wharton the 16th Day of Nov^r 1784 in Pursuance of
 a warrant dated the 6th Day of July 1784.

To John Lukens Esq^r }
 Surv^r Gen! } by W^m Gray D. S.

Now Luzerne-

IN TESTIMONY that the above is a copy of the original remaining on file in
 the Department of Internal Affairs of Pennsylvania, made
 conformably to an Act of Assembly approved the 16th day of
 February 1833, I have hereunto set my hand and caused
 the Seal of said Department to be affixed at Harrisburg,
 this eighth day of May 1907.

Henry Howell
 Secretary of Internal Affairs.